

85*120MM 128克铜板纸 打钉

蓝牙Wifi记录仪

Bluetooth WIFI Recorder



说明书
Instruction Manual



R1

R1 plus

目录

1. 产品特点介绍	4
2. 接口、按键详解	5
2.1 多功能按钮的功能、操作详解	6
2.2 旋钮的功能、操作详解	7
2.3 电源和Wi-Fi的功能、操作详解	8
3. 功能操作详解	9
3.1 如何使用手机查看录制的视频、图片?	9
3.2 如何设置显示时间与手机同步?	10
3.3 如何与手机、MP3、GPS、等进行蓝牙连接?	11
3.4 如何设置R1 plus进行两人对讲?	11
3.5 如何设置R1 plus进行多人对讲?	12
3.6 如何使用R1 plus连接对讲机?	12
4. 产品安装/拆卸/包装清单/参数规格	13
4.1 安装步骤	13
4.2 拆卸步骤	13
4.3 包装清单	14
4.4 规格参数	14
5. 常见故障排除	15
5.1 蓝牙不开机	15
5.2 记录仪不开机	15
6. 保修卡	29

1.产品特点介绍



内置摄像头

1080P 120° 广角镜头、
随时随地进行录像/抓拍



IP65 防水等级

有效保护产品在雨天也能正常使用



蓝牙5.0版本

蓝牙无线传输效率更高
无线对讲更稳定



R1 plus无线对讲功能

支持长达1000米，最多
6人同时连接对讲



Type C接口

大大减少充电时间，不
耽误您的骑行计划



WiFi技术

拍摄的视频和图片能够
高速传输到手机



连接对讲机

PTT控制线使您在骑行中
也能使用对讲机



语音提示

个性化的语音提示让您
及时了解当前操作



大容量电池

1500mAh高性能锂聚合物
电池，超长12天待机



语音呼叫

语音命令让手机语音助
手执行拨打电话等



充电使用

充电时也能使用产品，
不耽误您的骑行计划



连接2台手机

可同时连接2台手机，不
会漏接任何一个来电

2.接口、按键详解

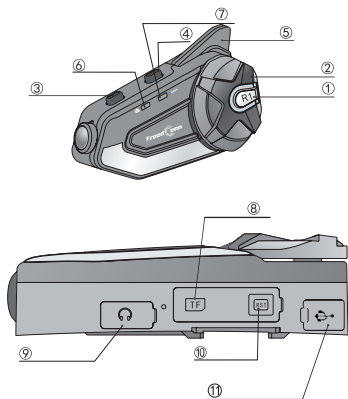

- ① 多功能键、蓝牙开/关键
- ② 旋钮
- ③ 记录仪开/关机键、录像键
- ④ WiFi按键
- ⑤ 天线
- ⑥ 录像指示灯
- ⑦ 蓝牙指示灯
- ⑧ TF卡槽
- ⑨ 耳机插孔
- ⑩ 复位键
- ⑪ 充电插口/对讲机连接线插口

2.1 多功能键的功能、操作详解



1. 蓝牙开机：按住多功能键约3秒，听到“欢迎使用Freedconn产品”提示音后松开。
2. 蓝牙关机：按住多功能键5秒钟，听到“关机”提示音后松开。
3. 蓝牙配对：在关机状态下，按住多功能键6秒不放，直到指示灯以红蓝灯闪烁后松开；此时您会听到“配对状态”提示音。
4. 接听电话：蓝牙对讲耳机与手机配对后，按一次多功能键接听电话；如没有任何操作，10秒后将自动接听来电。
5. 拒绝来电：有来电时，按住多功能键2秒后松开，此时您会听到“Dong Dong”提示音。
6. 电话语音切换：在呼叫过程中，按住多功能键2秒后松开，此时您会听到“Dong”提示音。
7. 结束通话：按一下多功能键结束电话通话。
8. 语音呼叫（或在手机上手动激活Siri）：蓝牙连接状态时双击多功能键，听见提示音“语音呼叫”时松手，或者直接在手机上手动激活Siri语音助手。
9. 清除配对记录：按住关机键看到红灯亮（听到关机提示音后）不松手持续再按住3S，看到红灯快闪三下（提示音嘟嘟）清除成功，并关机（正常按5S关机时不清除地址）。

10. (1) R1音乐播放/暂停: 按一次多功能键。
(2) R1 plus音乐播放暂停: 播放音乐时连续按两下多功能键暂停音乐, 顺时针旋转一下旋钮恢复播放。
11. R1中英文语言切换: 未连接任何设备的情况下, 开启蓝牙, 当语音提示“欢迎使用Freedconn产品”时, 双击多功能键, 进行中英文语言切换。
12. 音乐/FM切换: 音乐暂停时连续按两下多功能键切换到FM调频, 再连续按两下切回音乐模式。

2.2 旋钮的功能、操作详解

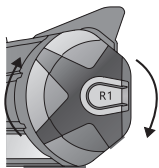

2.2.1 R1旋钮功能

- (1). 音量调节: 在呼叫/对讲/音乐播放过程中, 顺时针方向转动旋钮不松手, 以增加音量; 当音量达到最大值时, 听到“Du du”提示音。逆时针转动不松手以减小音量; 当音量最小时, 您将听到“du”提示音。
- (2). 音乐上/下曲: 播放音乐时, 逆时针转动旋钮播放上一首歌曲, 顺时针转动旋钮播放下一首歌曲。

2.2.2 R1 plus旋钮功能

- (1). 音量/FM调节：顺时针旋转旋钮到头不放，音量增大，增大至您想要的音量时放手，最大时会有“叮咚”提示音。逆时针旋转旋钮到头不放，音量减小，减小至你想要的音量时放手，最小时会有“叮咚”提示音。
- (2). FM调台：顺时针旋转一下旋钮换下一频段，逆时针旋转一下旋钮换上一频段。
- (3). 音乐上/下曲：顺时针旋转一下旋钮换下一曲，逆时针旋转一下旋钮换上一曲。
- (4). 通话/对讲时音量调节：通话/对讲时，逆时针扭转一下降低音量，音量到最小时会有“叮咚”提示音，时针扭转一下增加音量，增加音量到最大时会有“叮咚”提示音。

2.3 电源和WiFi键的功能、操作详解



2.3.1 录像功能

- (1). 按住“电源”开机键3s待绿灯亮（绿灯每隔3s闪一次）。开机状态下，插入“TF卡”短按开机键，或在连接wifi的情况下点击APP上的红色按钮再按一次“电源”进入视频录制状态，您将听到“录像开启”的提示音。

(2).再次按一下“⏏”停止录制，同时您将听到“录像暂停”的提示音。在录制时LED灯一直保持绿色。

(当存储卡容量不足时，新录制的视频将会自动替换第一个存储在内存卡的视频。个别卡满后不能循环录像，可以删除掉3-5个视频后方可自动循环录像)

(3).如果没有放入存储卡，您将听到“请插入内存卡”的提示音（最大支持64G存储卡）。

2.3.2 抓拍功能 录像状态下，短按“📶”进行抓拍。

2.3.3 WiFi功能

(1).在“录像功能”激活的状态下，按住“📶”键2-3秒打开WiFi，您将听到“WiFi开启”的提示音，同时绿灯每0.5s闪烁一次；

(2).在WiFi开启状态下，按住“📶”键2-3秒关闭WiFi，您将听到“WiFi关闭”的提示音，绿灯每间隔2S闪一次。

3.功能操作详解

3.1 如何使用手机查看录制的视频、图片？



1. 下载“GoPlus Cam” APP 到手机上(下图二维码是手机下载地址)
2. 打开手机上APP，点击中间“手机”图标
3. 选择wifi名为“FreedConn”后输入初始密码“12345678”进行连接
4. 返回到“GoPlus Cam” APP录像界面点击查看视频和图片，或者连接电脑，在我的电脑里面找到U盘，打开里面的视频或图片文件即可播放



安卓系统通过浏览器扫描二维码
下载，苹果手机在软件商店搜索
(GoPlus Cam)APP

3.2 如何设置显示时间与手机同步？

1. 下载“GoPlus Cam” APP 到手机上
2. 在R1/R1 plus上开启WiFi
3. 在手机上搜索WiFi
4. 打开“GoPlus Cam” APP，点击左下角的版本号，弹出设定 wifisport com时间，选择“启用”，进行时间设置。

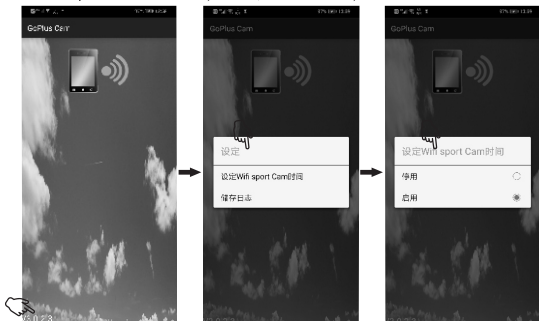

如图步骤

②创建 txt格式文件，将其重命名为userconfig.txt，编辑内容格式为年-月-日小时：分钟：秒，例如，2018-04-23 14: 51: 52，保存。然后复制到TF卡的根目录，插入卡到R1/R1 plus，然后启动R1/R1 plus，时间设置成功。最后，关闭R1/R1 plus 取出TF卡并删除文件。

3.3 如何与手机、MP3、GPS等进行蓝牙连接？

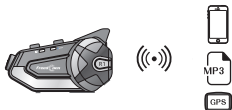

- (1). 确保主机关闭，将设备放置在1米可见范围内。
- (2). 关机状态下按住多功能键8秒，主机将自动进入配对状态。此时，蓝色指示灯与红色指示灯交替闪烁。
- (3). 打开要配对的蓝牙设备，搜索并选择R1/R1plus配对，您会听到“蓝牙已连接”的语音提示，待指示灯进入蓝灯有规律的闪烁后，表示配对已成功。

3.4 如何设置R1 plus进行两人对讲？



- (1). 确保两个设备都为关机状态，并放在1米可视范围内。
- (2). 同时按住两个设备的开关机键8秒，听到语音提示“配对状态”此时，指示灯红蓝灯交替闪烁，两个设备都进入待配对状态。注意：如果不能进入红蓝灯交替闪烁状态，请先进行清除配对记录操作，然后再重复以上操作。
- (3). 按一下其中一台的开关机键进行配对，它会自动搜索另一台设备，您会听到“对讲已连接”待指示灯进入蓝灯有规律的闪烁后，表示配对已成功。

3.5 如何设置R1 plus进行6人对讲?

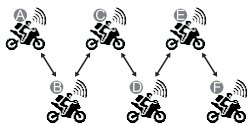

注意：首尾队员（如图中A和F）决不能配对连接。



(1). 清除A、F的配对记录。

按住A、F的开关机键8秒，听到提示音“关机”继续按住3秒。

(2). 以下操作参考第11项的配对操作方式。

① A与B配对，配对完成后，将B关机；(注意:只是关机，不要清除配对记录)

② B与C配对，配对完成后，将C关机；

③ C与D配对，配对完成后，将D关机；

④ D与E配对，配对完成后，将E关机；

⑤ E与F配对。(此时，ABCDEF都为开机状态...)

(3). 将ABCDEF进行串连。

① D按一下开关机键连到E，会听到一串对讲提示音；

② C按一下开关机键连到D，会听到一串对讲提示音；

③ B按一下开关机键连到C，会听到一串对讲提示音；

④ A按一下开关机键连到B，会听到一串对讲提示音；

(此时，ABCDEF配对成功，可以进入群组通话。)

3.6 如何使用R1/R1 plus连接对讲机?

(1). 如下图所示，在R1/R1 plus开机状态下使用PTT控制线连接对讲机；

(2). 将PTT魔术粘贴带绑定在摩托车的车把上；

(3). 将PTT控制线的PTT键粘贴在魔术粘贴带上；

(4). 将对讲机放置在合适位置，在骑行过程中即可通过按压PTT按键使用对讲机讲话

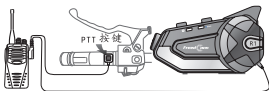

注意：在使用过程中，相应功能的优先级顺序为“电话>PTT对讲>音乐/GPS/语音提示”。

4. 产品安装、拆卸/包装清单/参数规格

4.1 安装步骤

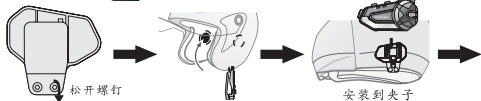

将夹子插入头盔上(用力过大会导致夹子断裂)



4.2 拆卸步骤

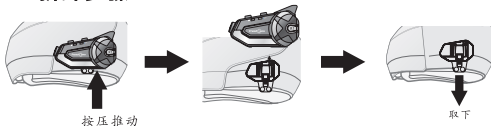

4.3 包装清单



① 蓝牙主机



② 麦克风&喇叭



③ 夹子



④ 螺丝刀



⑤ PTT魔术贴粘带



⑥ 耳机魔术贴



⑦ 数据线



⑧ 对讲机控制线

4.4 产品规格参数

频率：2.4 GHz

重量：77克

尺寸：98 x58 x30 mm

电源适配器：DC 5V/1A

镜头：1080P

通话时长：30小时

录像时间：4.5小时

充电时间：约2小时

待机时间：12天

音乐时间：48小时

电池容量：1500 mAh (电量低时会有“电池电量低，DVR关机”语音提示，并且每60秒会有“嘟嘟”提示音，此时录像/抓拍功能无法使用；电池电量过低时，蓝牙会自动关机。充电过程中，红灯保持常亮状态。)

5. 常见故障排除

5.1 蓝牙不开机

当记录仪能开机，蓝牙开不了机的情况下，通常是由于蓝牙在关机时没有成功复位所致，此时只需要将机器上的复位按键按下约3秒以上即可成功复位。

5.2 记录仪不开机

在确认机器电量充足的情况下，如果记录仪开不了机，通常是由于记录仪在关机时没有成功复位所致，此时只需要将机器上的复位按键按下约1秒即可成功复位。

5.3 打开APP查看视频时听音乐出现卡顿

打开APP查看视频时因视频码流较大，所以会对蓝牙产生干扰，需要临时关闭蓝牙，待退出APP后方可开启蓝牙。

5.4 手机播放视频时有“噼里啪啦”杂音

用手机APP下载下来的视频首次播放时需要关闭4G流量和WIFI，这样就不会有“噼里啪啦”杂音出现。

Catalogue

1. Product's Features	17
2. Ports&Buttons Introduction	18
2.1 Operation and Functions of the Multi-function Button	19
2.2 Operation and Functions of the Wheel	20
2.3 Operation and Functions of the "⏻" and "📶" Button	21
3. Operations for the Main Funtions	22
3.1 How to view the videos and photos on Phone?	22
3.2 How to set the display time to synchronize with Phone?	23
3.3 How to pair R1/R1 plus with Phone/MP3/GPS?	23
3.4 How to set R1 plus to intercom between 2 persons?	24
3.5 How to set R1 plus to intercom between multiple persons?	24
3.6 How to set R1/R1 plus to connect with walkie-talkie?	25
4. Installation/Uninstallation/Packing/Specifications	26
4.1 Installation Steps	26
4.2 Uninstallation Steps	26
4.3 Packing List	27
4.4 Specifcaions	27
5.Frequently Asked Questions	28
5.1 Bluetooth can not be Turn On	28
5.2 WiFi recorder can not be Turn On	28
6.Warranty Card	30

1. Product's Features



Built-in Camera

with built-in 120°1080P camera, users can take videos and snap photos at any time



IP65 Waterproof Level

IP65 waterproof level can protect the product very well even using in the rainy weather



Bluetooth 5.0

wireless transmission is more efficient and the bluetooth intercom will be more stable



Wireless Intercom(R1 plus)

supports up to 6 people, 1000 meters wireless bluetooth intercom within the same group



Type-C Port

greatly decrease the charging time, help to save your time and never delay the riding plan



WiFi Technology

WiFi technology enables the videos and photos to be wirelessly transmitted with high speed



Connect Walkie-talkie

packing with PTT controlling line so the users can use the walkie-talkie during the riding



Voice Reminder

voice reminder will keep you know the operations and the product's working status timely



Large Battery Volume

up to 1500mAh chargeable Lithium Polymer Battery, standby time can be waiting about 12 days



Voice Calling

supports to activate the voice assistant of your Phone to make Phone calls via the voice command



Using when in Charging

equipped with two independent ports, users can use product even the it is in the charging



Connect 2 Phones

supports to connect 2 Phones simultaneously so you will never miss any coming Phone calls

2. Ports & Buttons Introduction

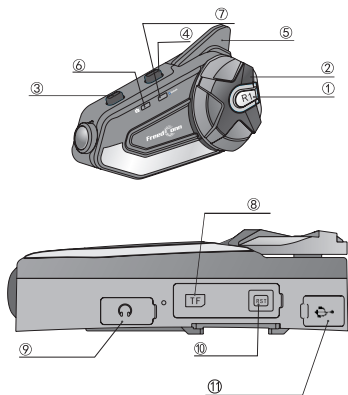

- ① Multi-function Button & Bluetooth On/Off Button
- ② Wheel
- ③ Recorder & Camera On/Off button
- ④ WiFi Button
- ⑤ Antenna
- ⑥ Indicator for Recorder
- ⑦ Indicator for Bluetooth
- ⑧ TF Card Slot
- ⑨ Headphone Port
- ⑩ Reset Button
- ⑪ Charging Port & Walkie-talkie Port

2.1 Operation and Functions of the Multi-function Button



- 1. Bluetooth on:** Press and hold the Multi-Function button (for about 3s) until hearing "Welcome to use FreedConn product".
- 2. Bluetooth off:** Press and hold the Multi-Function button (for about 5s) until hearing "Power Off".
- 3. Bluetooth pairing:** In the "Off" status, press and hold the Multi-Function button (for about 6s) until hearing "Pairing", the indicator will become quickly flashing red & blue colors.
- 4. Answer calls:** Press the Multi-function button for 1 time when there is coming phone call. If no any operations, it will answer the phone call automatically in 10s.
- 5. Reject calls:** Press and hold the Multi-Function button (for about 2s) until hearing "Dong Dong".
- 6. Audio switching:** During the phone call answering status, press and hold the Multi-Function button (for about 2s) until hearing "Dong".
- 7. Terminate call:** During the phone call answering status, press the Multi-function button for 1 time to end.
- 8. Voice Call (via the Voice Assistant of the Phone):** Double-click the Multi-function button in the bluetooth connected status. After successfully activating the voice assistant, you could command the phone to conduct calls.
- 9. Clear the pairing record:** Press and hold the Multi-Function button (for about 8s) until hearing "DuDU", and the red indicator will flash quickly for 3 times.
- 10. (1) Music play/Pause (R1):** Press the Multi-function for 1 time to play/pause the music.
(2) Pause music on R1 plus: Press the multi-function key twice to pause while playing music, turn the knob clockwise for once to re-play music.

11. **Switch Language(only for R1):** Press and hold the Multi-Function button(for about 3s) until hearing “Welcome to use FreedConn product”. And after that, double-click the Multi-function button to switch the languages between Chinese and English.

12. **Music / FM switching:** When music is paused, press the multi-function key twice to switch to FM radio. Press twice again to switch back to music mode.

2.2 Operation and Functions of the Wheel

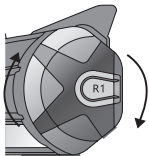

2.2.1 Wheel Function of R1

(1). **Volume Adjustment:** Turn the wheel in clockwise direction to increase the volume. When the volume reaches the maximum level, there will be “DuDu” voice reminder. Turn the wheel in anti-clockwise direction to decrease the volume. When the volume reaches the minimum level, there will be “Du” voice reminder.

(2). **Switch Music:** Turn the wheel in clockwise direction to play next song and in anti-clockwise direction to play last song.

2.2.2 Wheel Function of R1 plus

(1). **Music/FM volume control:** Turn the wheel clockwise to the end and hold the wheel until the volume increases to the suitable level. When the volume reaches the maximum level, there will be “DuDu” voice reminder. Turn the wheel anti-clockwise to the end and hold the wheel until the volume decreases to the suitable level. When the volume reaches the minimum level, there will be “DuDu” voice reminder.

(2). **FM Channel Switch:** Turn the wheel in clockwise for 1 time to play next station and turn the wheel in anti-clockwise for 1 time to play last station.

(3). **Switch Music:** Turn the wheel in clockwise direction to play next song and in anti-clockwise direction to play last song.

(4). **Talking/Intercom Volume Control:** When you are answering call or in the bluetooth intercom status, Turn the wheel in clockwise direction for 1 time to increase the volume. When the volume reaches the maximum level, there will be "DuDu" voice reminder. Turn the wheel in anti-clockwise direction for 1 time to decrease the volume. When the volume reaches the minimum level, there will be "Du" voice reminder.

2.3 Operation and Functions of the "U" and "Wi-Fi" Button

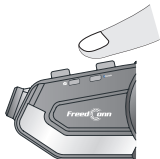

2.3.1 Operations for Video Recording

(1). Press and hold the "U" button (for about 3s) until hearing "dingding..." to turn on the camera function. After that, click the "U" button again can start the video recording (You will hear "Video Recording" voice reminder) and one more click will end the video recording (You will hear "Video Recording Stopped" voice reminder). (If the video recording status lasts for long time, the video will automatically be broke in segments for every 3 minutes and saved in the TF card.)

(2). If there is no TF card inside, there will be "No SD Card" voice reminder. Please insert SD card, otherwise the video recording or capturing photo function can not be used. (Supports Max 64G SD card) (Attention: Video Cycling Recording may automatically stop when the TF card is full, please delete some files and re-try.)

2.3.2 Operations for Snap Photos

During the video recording status, click the "Wi-Fi" button for one time to take a snap photo. Multiplely click the "Wi-Fi" button will take multiple snap photos.

2.3.3 Operation for Wi-Fi connection

Press and hold the "Wi-Fi" button (for about 3s) until hearing "Wi-Fi turned on" reminder. After that please activate the WLAN function on your phone and choose the "Freedconn" WiFi name to connect. If it requires password,

please enter "12345678" and confirm to continue.

Note: Before connected to the WiFi with your Phone, video recording or capturing photos can be used normally.

3. Operations for the Main Functions

3.1 How to view the videos and photos on Phone?



1. Download the APP(GoPlus Cam) on your Phone; (below QR code is the download address)
2. Press and hold the "WiFi" button(for about 3s) until hearing "WiFi turned on" reminder;
3. Activate the WLAN function on your phone and choose the "Freedconn"WiFi name to connect. If it requires password, please enter "12345678" and confirm to continue;
4. Open the "GoPlus Cam" APP on your Phone and view the videos or photos. (You could also check the saved videos or photos on your computer via Udisk.)



For mobile phone of Android system installation: pls. Scan QR code through browser
For mobile phone of Apple system installation: pls. search and download GoPlus Cam App from the App Store.

3.2 How to set the display time to synchronize with Phone?

1. Click the "GoPlus Cam" icon on your phone to open the APP. (Connected your Phone with the WiFi before doing this.)
2. Click the "Version Number" on the left bottom corner.
3. Click "Set the Wifi Sport Cam Time" option and choose "Enable" in the coming page. (See the below pictures)

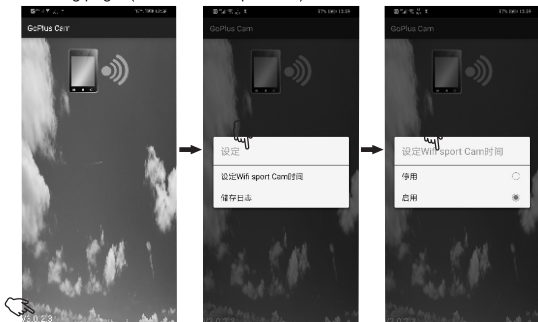

see the diagram for reference

- 2 Create a txt format file on the computer and rename it as "userconfig.txt", and then open it and edit the content as "xx Year-xx Month-xx Day xx Hour: xx Minute: xx Second", such as: 2019-01-01 15:33:56, and then save. Copy the file to the root directory of the SD card and then insert the SD card into the R1/R1 plus. Turn on R1/R1 plus, the display time will automatically synchronize with the Phone.

3.3 How to pair the R1/R1 plus with Phone/MP3/GPS?

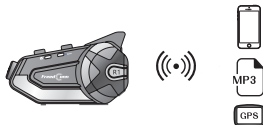

- (1) .Press and hold the Multi-function button(for about 8s) until the LED indicator becomes flashing Red&Blue colors. This time the bluetooth is in the pairing status.
- (2) .Activate the Bluetooth function of your Phone/MP3/GPS and search the surrounding available bluetooth.
- (3) .Find the "R1" or "R1 plus" on the bluetooth list and choose to connect. After successfully connected, there will be "Connected" voice reminder.And the LED indicator will become flashing blue color.

3.4 How to set R1 plus to intercom between 2 persons?



- (1) .Press and hold the Multi-function button(for about 8s) on two R1 plus simultaneously until the LED indicator becomes flashing Red&Blue colors. This time the bluetooth is in the pairing status.And you will hear "Pairing" voice reminder.
- (2) .Click the multi-function button for 1 time on any one of them. They will search and connect with each other automatically.
- (3) .After successfully connected, there will be "Connected" voice reminder and the LED indicator will become regular blue color.

3.5 How to set R1 plus to intercom between multiple persons?

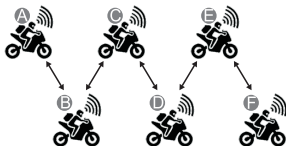

Note: The foremost and backmost cyclers (shown as A and F in figure) are not allowed to be paired.



(1). In the "On" status, press and hold the Multi-function button of A and F for about 11s. (You will hear "Power Off" voice reminder and then press and hold for another 3s.)

(2). Refer to the pairing method between two persons to finish the pairing from A and F.

① After paired A and B, turn off B.

② After paired B and C, turn off C.

③ After paired C and D, turn off D.

④ After paired D and E, turn off E.

⑤ After paired E and F, please operate as the following instructions. (This time all the devices are turned on.)

(3). Connect A, B, C, D, E, F in the order of tandem.

① Click the Multi-function button of D for 1 time to connect with E, there will be "Connected" voice reminder.

② Click the Multi-function button of C for 1 time to connect with D, there will be "Connected" voice reminder.

③ Click the Multi-function button of B for 1 time to connect with C, there will be "Connected" voice reminder.

④ Click the Multi-function button of A for 1 time to connect with B, there will be "Connected" voice reminder.

3.6 How to set R1/R1 plus to connect with walkie-talkie?

(1). Connect R1/R1 plus to the walkie-talkie with the PTT controlling line;

(2). Bind the PTT velcro tape onto the handlebar of the motorbike;

(3). Stick the PTT button onto the velcro tape;

(4). Place the walkie-talkie in a suitable place so you could use the walkie-talkie while you are riding.

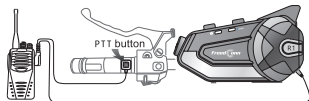

Note: the priorities are as below if different functions are working in conflict, Phone Call>PTT Intercom>Bluetooth Music/GPS/Voice Reminder.

4. Installation/Uninstallation/Packing/Specifications

4.1 Installation Steps

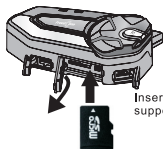

Insert the memory card
support max 64G TF card

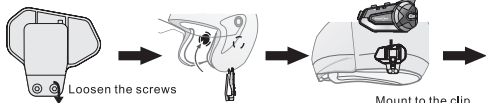

Loosen the screws

Mount to the clip

Insert the clip on the helmet (heavily fasten the screw will damage the clip.)



Insert the headphone plug into the jack on BT receiver to finish the installation

4.2 Uninstallation Steps

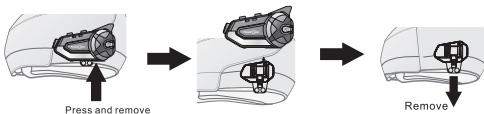

Press and remove

Remove

4.3 Packing List



1 Bluetooth device



2 Microphone & speaker



3 Clips



4 Screw driver



5 PTT VELCRO tape



6 Headphone Velcro



7 USB cable



8 Walkie-talkie PTT control cable

4.4 Specifications

Frequency: 2.4GHz

Weight: 77 grams

Size: 98mm (L) x 58mm (W) x 30mm (H)

Compatible Power adapter: DC 5V/1A

Lens: 1080P

Phone Talking: 30 hours

Video recording : 4.5 hours

Charging time: about 2 hours

Standby time: 12 days

Music time: 48 hours

Battery capacity: 1500mAh (There will "Battery Low DVR Power Off" voice reminder when the battery is low, and there will be "dudu" reminder in every 60s. This time the Video recording/Photo function can not be used. And when the battery is too low, the bluetooth will turn off automatically. Indicator will stay in Red color during the Charging status.)

5.Frequently Asked Questions

5.1 Bluetooth can not be Turn On

If the Bluetooth can not be turn on but the WiFi recorder can be turn on, it is usually because the bluetooth was not successfully reset after turn off. Please press and hold the "Reset" button for over 3s to reset the bluetooth and then try to turn on the bluetooth again.

5.2 WiFi recorder can not be Turn On

If the WiFi recorder can not be turn on even though the battery voltage is high enough, it is usually because the WiFi recorder was not successfully reset after turn off. Please press and hold the "Reset" button for over 1s to reset the WiFi recorder and then try to turn on the WiFi recorder again.

5.3 There is a freeze when listening to music when opening the APP to view the video

When opening the APP to view the video, due to the large video stream, it will interfere with Bluetooth,Bluetooth needs to be temporarily turned off, and can only be turned on after exiting the APP.

5.4 There is "crackling" noise when playing video on mobile phone

4G data and WIFI need to be turned off when the video downloaded with the mobile app is played for the first time.In this way, there will be no crackling noise.

保修卡

型号: R1/R1 plus

2^年
保修期

请保存好您的购物收据、保修卡和撕毁无效标贴

姓名: _____

地址: _____

☎ _____

售后服务: service@fdcdz.com

故障描述:

请在保修卡后面贴上收据的复印件, 以证明购买日期。

使用过程中如发现产品有故障, 请联系我们的售后服务。

请确保在保修卡上填写清楚产品的故障、问题等, 以便我们及时为您处理。

R1 R1plus



Warranty Card

Model Number :R1/R1 plus



Please keep your purchase receipt together with your warranty card & "invalid if removed" label

Name: _____

Address: _____



After sale service: service@fdcdz.com

Failure Description:

Please affix a copy of invoice on the back of warranty card as a proof of purchase date. If you find any problems during use of our product, please contact our after sale service. Please make sure that you describe the problems clearly on warranty card so that we can handle them timely.

R1 R1plus



FreedConn®

20200417 V0.2

